

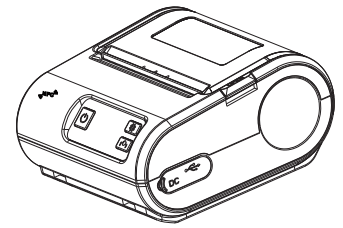

PORTABLE THERMAL PRINTER

User Manual



Please keep user manual for reference

Mobile Barcode Printer

Warning : The content of this manual cannot be changed without permission. The company reserves the rights to modify the technology, components, software and hardware. You may ask the distributors for more product information. Any chapters in this manual cannot be copied or transmitted in any format.

This product is a Class A product and may cause radio interference in a living environment. In this case, the customer may be required to take practical measures to interfere with it.

Packing

Printer	1PC
Battery	1PC
User manual	1PC
USB Cable	1PC

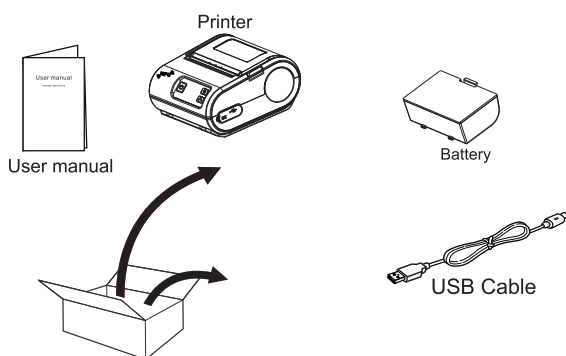

The mobile printer can work with both continuous paper and non-continuous paper.

- (1) Continuous paper: Strip-shape roll paper without adhesive.
- (2) Non-continuous paper: Thermal label paper without adhesive and thermal adhesive sticker.

Remark: Toggle the paper baffle switch forward and backward to lock or open the left and right movement function of the paper stop.

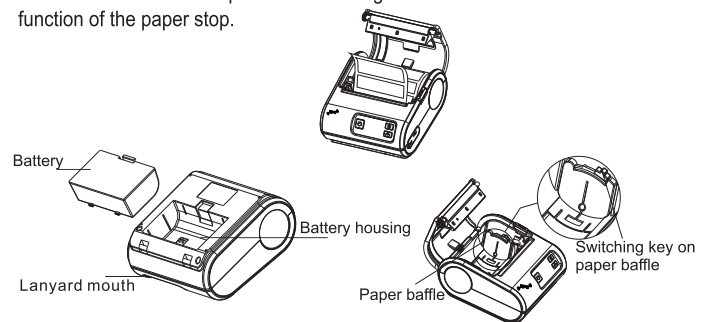

⚠ Note: The battery protective film needs to be removed before use, otherwise the printer will not be powered on.

⚠ The pictures are for reference only, please refer to the actual packaged items. The appearance and accessories of different models are slightly different.

Please follow the below steps to install paper roll:

- Open top cover
- Drop in the paper roll as the below illustration shows
- Pull out a small segment of paper and close the paper roll cover
- Print a self-test page to make sure the paper is correctly installed

Function Overview

1.Button&Indicator

- (1) Power Button (⏻)
- (2) FEED Button (⏪)
- (3) Set Button (⚙)
- (4) LED Screen
- (5) NFC Sensing Area
- (6) Battery Status Indicator

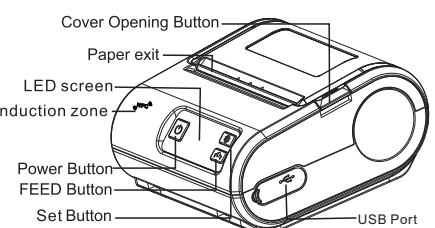

2. Buttons

No.	Function	Description
1	Feed	Press FEED button when LED screen is .Then printer would feed the paper to the front next label .
2	Pause	Press the SET button while the printer is printing and the printing task will be paused .
3	Self-test	(1)Make sure the paper has been installed and top cover is closed under power-off status. (2)Press FEED button and do not release.And then press the POWER button until printer is power-on.Then release the FEED button and a self-test page will be printed.
4	Set	Press this button to perform functional selection.

3.NFC Sensing Area.

Open the NFC function of mobile phone and the mobile phone is close to the NFC sensing area of the printer and then the XPrinter APP download interface will appear. You can print directly if the mobile phone has installed the Xprinter APP.

4.Battery performance:

- (1) Power supply:7.2V/2500mAh rechargeable polymer lithium battery.
- (2) Power adapter is not included in standard accessories.
- (3) Charge mode:
USB charge: DC 5V/2A.
- (4) Quick charge:Battery can be fully charged in about 4 hours.
- (5) One-time charging use time: Print about 200m at 25% print density and standby time is 7days.

! To protect battery's service life, please charge the battery before it completely runs out. Battery performance will decline with the times of charging & discharging increase when the times of battery charge & discharge ≥ 500 times. The above parameter is used for reference. The battery performance might decline gradually as the service time runs.

3

Cautions:

- 1.The printer can only work with the dedicated battery & power adapter. Otherwise, it may cause harm to the printer.
2. If the printer will not be used for a long period of time, the battery must be taken out of the printer. Otherwise, it may cause battery leakage.
3. The fluid of battery used in the printer is caustic. If accidentally the battery leaks and the fluid is put on skin or clothes, please flush with running water immediately. And if the fluid gets into eyes, please go to hospital immediately.
4. The printer must not be put into water or exposed to rain. Otherwise, it may cause harm to the printer.
5. Although the printer can work in environment temperature between 0°C to 40°C, it may affect printing quality if environment temperature is too low or too high.

Print-head cleaning:

Timely clear printer-head in one of the below cases:

1. Unclear printing.
2. Unclear vertical column in printing paper.
3. Loud noise when feeding.

Cleaning steps are as follows:

1. Turn off the printer and open the top cover. Remove the paper if any.
 2. Temperature of print-head can be very high right after finishing the printing task. Please clean print-head after it cools down to environment temperature.
 3. Clean the thermal elements of thermal head with a soft cotton cloth moistened with absolute ethyl alcohol.
 4. Close the top cover after the absolute ethyl alcohol completely volatilized.
- Then printer self-test page.

! Notice :

- 1.Please make sure power off when maintaining printer.
- 2.Don't touch or scratch printing head surface by hands or metal materials.
- 3.Avoid using gasoline, acetone or other organic solvent.

5

5. LED screen is instructions

No.	Function	Choice	Description
1	Paper type	Continuous paper	Default bill mode after selection
		Blacklabel paper	Default Blacklabel mode after selection
		Label paper	Default label mode after selection
2	Print density	Dense medium light	Select printer density (three options)
3	Label calibration	Start	When start is selected, the printer automatically performs gap detection
4	Automatic calibration	Start	After the printer is turned on, the label gap is automatically detected when the printer is powered on and the switch cover is printed.
		Shut down	When the printer is powered on and the cover is switched off, the printer will not automatically detect the label gap.
5	Self test	Determine	After selecting, print out the testpage (program version, date, etc.)
6	Interface language	Chinese	After choosing Chinese, all of the LED screen is displayed in Chinese.
		English	After choosing English, all of the LED screen is displayed in English.
7	Initialization	Determine	After selection, restore all settings to the factory default values
8	Sleep time	3 minutes / 5 minutes / 10 minutes / no sleep	When selected, the printer will enter the low-power state (except charging and printing) within the corresponding time
9	Power OFF time	0.5 hours / 1 hour / 2 hours / 3 hours / no shutdown	After selecting the time, the printer will automatically shut down during the standby time
10	Printer information	Display	After selection, you can view the Bluetooth information, product name, program version number and date of the printer

4

- 4.Turn on the printer and continue print task after the absolute ethyl alcohol completely volatilized.
5. The product has a built-in lithium battery, please do not use it in a high temperature environment above 45 °C. Please do not place it near fire or other heat sources. Please do not place it in hot sunlight, otherwise it will cause explosion or fire hazard.
- 6.The replacement battery must use the same specification battery, otherwise there is a danger of explosion.
7. Used batteries should be recycled or disposed of in accordance with local regulations and product instructions.

STATEMENT

This device complies with Part 15 of the FCC Rules. Operation is subject to the following two conditions: (1) this device may not cause harmful interference, and (2) this device must accept any interference received, including interference that may cause undesired operation.Changes or modifications not expressly approved by the party responsible for compliance could void the user's authority to operate the equipment.

NOTE: This equipment has been tested and found to comply with the limits for a Class B digital device, pursuant to Part 15 of the FCC Rules. These limits are designed to provide reasonable protection against harmful interference in a residential installation. This equipment generates, uses instructions, may cause harmful interference to radio communications. However, there is no guarantee that interference will not occur in a particular installation. If this equipment does cause harmful interference to radio or television reception, which can be determined by turning the equipment off and on, the user is encouraged to try to correct the interference by one or more of the following measures:

- Reorient or relocate the receiving antenna.
- Increase the separation between the equipment and receiver.
- Connect the equipment into an outlet on a circuit different from that to which the receiver is connected.
- Consult the dealer or an experienced radio/TV technician for help.

6