



PORTABLE THERMAL PRINTER

User manual



Thermal Barcode Series

Printer Installation

- 1 Open the printer power of paper loading**
Find the cover switches above the printer and press it down with your fingers to open the cover

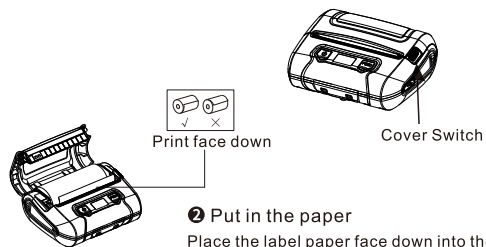

- 2 Put in the paper**
Place the label paper face down into the printer paper bin, pull the label paper out of the bin for a short section and close the cover.

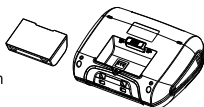

Printer paper limit slide

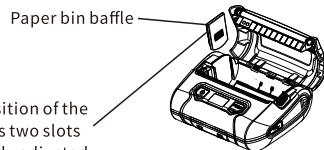
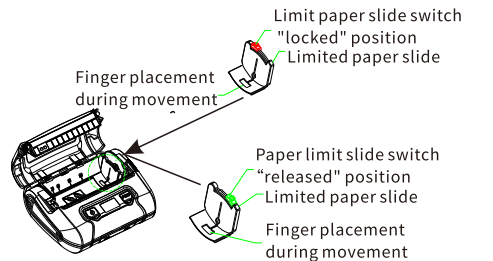

The placement position of the paper bin baffle has two slots in total; Can be freely adjusted according to the size and position of the paper roll; Select slot 1 or slot 2

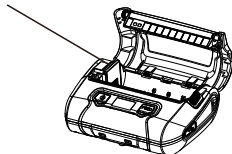

APP Download

- a Scan the QR code below on your phone to download and print an app**



- b More software usage instructions can be viewed in the APP**

Special Instructions

- ⚠ When connecting Bluetooth, you need to turn on the Bluetooth of the mobile phone, and agree to the software positioning permission, and the PIN code is 0000 by default

Packing List



Label printer*1



Power adapter*1



Battery*1



Type-c cable*1



CD*1



User manual*1

Boot Function:

After turned on the printer we can via the Power on Menu to set up or test the printer. Press and hold the FEED button while pressing the power button, release the power button when the screen is lit, and then release the FEED button with the display information to activate these functions.

Power on Menu	Display information
Sensor correction	Calibrate
Print selftest check page and enter debugging mode	Self Test
Printer initialization	Initialize

1. Printer Buttons & Display Screen:

(1) Power button (POWER)

- A. Power on: Press and hold the power button 5S in the shutdown state, and the printer enters the working state.
- B. Power off: Press and hold the power button for 2 seconds while the printer is turned on to shut down.
- C. Force shutdown: If the printer has an unknown error, press and hold the power button 6S to force shutdown.
- D. Menu return: Press the power button while the menu is open to return to the upper menu.

(2) Menu button (MENU)

- A. Open the menu: The display shows the standby state, press the menu button to enter the menu.
- B. Option confirm: Press this button to determine the option while the menu is open.

(3) FEED Button

- A. Paper feeding function: Press this button can feed a piece of paper.
- B. Flip down function: When the menu is open, press this button to select flip down.

(4) Display Screen

The display shows information such as printer status, battery level, etc.

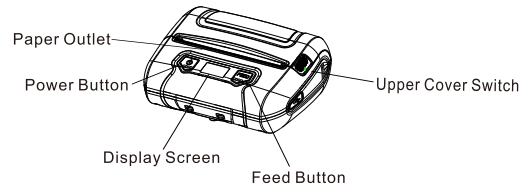

► The print head should be cleaned in time when the printer has one of the following conditions:

1. Unclear printing
2. High paper feeding noise
3. Dirt adhered to the print head

► The cleaning steps are as below:

1. Turn off the power of the printer, open the upper cover, if there is paper, remove it;
2. If printing has been just completed, please wait for the print head to completely cool down;
3. Wipe off dust and stains on the surface of the print head with a soft cotton cloth dipped in anhydrous ethanol (which should be wrung dry);
4. After the anhydrous ethanol has completely evaporated, load the paper and then close the upper cover to retest the printing.

▲ Points for Attention:

- (1) During the daily maintenance of the printer, it is necessary to ensure that the power is turned off;
- (2) Do not touch the surface of the print head with your hands and metal objects, and do not use tools such as tweezers to scratch the surface of the print head, printing glue and sensor;
- (3) Do not use organic solvents such as gasoline and acetone;
- (4) Wait until the anhydrous ethanol completely evaporated, before turning on the power to continue printing;
- (5) This product is equipped with a built-in lithium battery, please do not use it in environment with temperature above 45 °C, do not approach heat sources such as open flames, and do not place or use it in sourcing sunlight, otherwise it will cause explosion or fire hazards;
- (6) Do not disassemble and replace the battery without permission, the replacement battery must use the same specification battery, otherwise there will be a risk of explosion;
- (7) The recycling or disposal of waste batteries should comply with local regulations and product manuals.

The manufacturer has the right to modify the contents of the manual without prior declaration!



The contents of this manual can not be changed without approval agreed, ur company reserves the right to change the product software and hardware in terms of the technology and spare parts. If necessary, users can use it together with the product. You can contact the dealer to find more information. Without permission, no chapter of this manual may be reproduced or disseminated in any form or by any means.